

# B250006

# 250

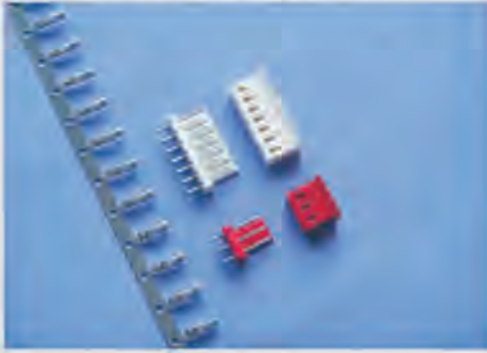

- ▶ 主要技术特性 (Main Specifications)
- ▶ 适用导线规格 (Applicable wire) : AWG28#~22#
- ▶ 适用基板厚度 (Applicable PC board thickness) : 1.2mm~1.6mm
- ▶ 温度范围 (Temperature range) : -25°C~+85°C
- ▶ 额定电压 (Voltage rating) : 250V AC, DC
- ▶ 额定电流 (Current rating) : 2A AC, DC
- ▶ 接触电阻 (Contact resistance) :  $\leq 0.02\Omega$
- ▶ 绝缘电阻 (Insulation resistance) :  $\geq 1000M\Omega$
- ▶ 耐压 (Withstanding voltage) : 1000V AC/minute

### 材料及电镀规格 Material and Finish

型号 Type	材料 Material	材料厚度 Material Thickness	电镀规格 Finish
插座 WAFER	塑胶 HOUSING	PA66 UL94V-0	N/A
	针PIN	黄铜 Brass	镀锡 Tin-plated
孔座 HOUSING	PA66 UL94V-0	—	N/A
端子 TERMINAL	锡青铜 Phosphor bronze	0.2mm	镀锡 Tin-plated

### 产品尺寸图 Product size chart

 单位: mm 一般公差:  $\pm 0.20$ 

### TERMINAL

B250006-4 250

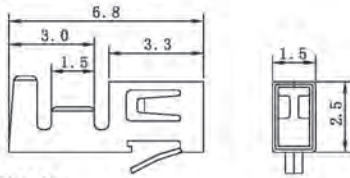

### HOUSING

B250004-2

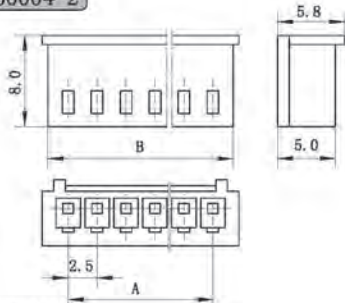

### HOUSING

### WAFER

B250006-1

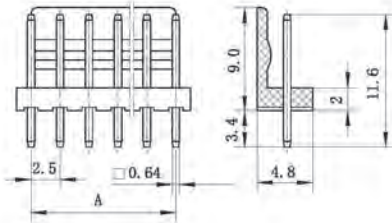

### 安装尺寸 (Mounting measurement)

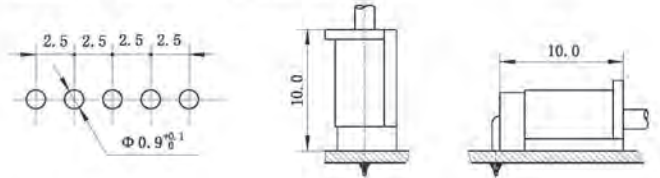

B250006-1W

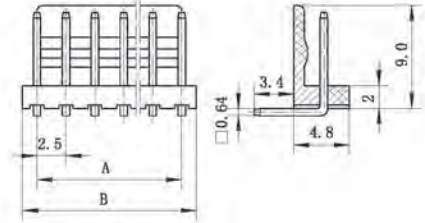

极数 Circuits	型号 Type	尺寸 (Dimensions) mm		备注型号 P. S. Type
		A	B	
2	B250006-2-02	2.5	6.0	250-02Y
3	B250006-2-03	5.0	8.5	250-03Y
4	B250006-2-04	7.5	11.0	250-04Y
5	B250006-2-05	10.0	13.5	250-05Y
6	B250006-2-06	12.5	16.0	250-06Y
7	B250006-2-07	15.0	18.5	250-07Y
8	B250006-2-08	17.5	21.0	250-08Y
9	B250006-2-09	20.0	23.5	250-09Y
10	B250006-2-10	22.5	26.0	250-10Y
11	B250006-2-11	25.0	28.5	250-11Y

# B250006

# 250

## WAFER

极数 Circuits	型号 Type		尺寸(Dimensions)mm		备注型号 P. S. Type	
			A	B		
2	B250006-1-02	B250006-1W-02	2.5	7.5	250-02A	250-02AW
3	B250006-1-03	B250006-1W-03	5.0	10.0	250-03A	250-03AW
4	B250006-1-04	B250006-1W-04	7.5	12.5	250-04A	250-04AW
5	B250006-1-05	B250006-1W-05	10.0	15.0	250-05A	250-05AW
6	B250006-1-06	B250006-1W-06	12.5	17.5	250-06A	250-06AW
7	B250006-1-07	B250006-1W-07	15.0	20.0	250-07A	250-07AW
8	B250006-1-08	B250006-1W-08	17.5	22.5	250-08A	250-08AW
9	B250006-1-09	B250006-1W-09	20.0	25.0	250-09A	250-09AW
10	B250006-1-10	B250006-1W-10	22.5	27.5	250-10A	250-10AW